



## WARRANTY STATEMENT

### Renaissance – Stage 2

#### Blinds Packages (Manual chains operated)

- Living Areas : Translucent, Shaw. Le reve / Pewter
- Bed rooms : Blockout, Shaw. Le reve / Pewter
- Components : JAI products (Chain controllers, Metal chains, Bottom bars)
- Powder-coated aluminium pelmets in white

#### Sheer curtains Packages

- Living Areas : Translucent. Nettex. Bali / Pearl
- Bed rooms : Translucent. Nettex. Bali / Pearl
- Components : S/wave curtains tracks in white , Aluminium Flick sticks in white

CIANI ACT Pty Ltd ACN 633 514 262 warrants that products supplied and installed by CIANI ACT (**Blinds , Curtains and Components**) will be free from all defects due to faulty design, materials or workmanship (either in the Goods or installation for five (5) years).

Misuse, alterations and repairs to the product not carried out by CIANI ACT, improper cleaning, outdoor use, treatment with chemically aggressive agents, and external influences (incl. damage, insects, polluted condensation) do not fall within the scope of the warranty.

These warranty conditions supersede all previous and existing materials relating to warranties published by CIANI ACT.

This warranty is not transferrable, and only the original purchaser of the products can make a claim under this warranty.

## WHAT THE WARRANTY COVERS

This warranty covers the repair or replacement of any defective material or component in CIANI blinds. CIANI ACT provides a manufacturer's warranty that your CIANI blinds/sheers will be free from defects in material and workmanship for a maximum of five (5) years from the date of CIANI ACT invoice.



You are also entitled to have the product repaired or replaced if the product is defective. Minor failures to comply with a consumer guarantee can normally be fixed or resolved in a reasonable amount of time.

This warranty is valid when payment for the CIANI ACT product has been made in full and proof of purchase is provided to CIANI ACT.

## **THE WARRANTY DOES NOT COVER**

- Marks or imperfections in, holes or runs in, or fraying of the material which occurs more than 30 days after installation.
- Any conditions caused by normal wear and tear.
- Alterations and repairs to the product carried out by a distributor/ specialist, water damage, accidents, misuse, or incorrect installation.
- Exposure to the elements (sun damage, wind or rain), discolouration over time.
- Any damage caused by insect increments.
- Any damage resulting from exposure to high moisture and high humidity environments (resulting in mould, mildew or fungal growths) e.g. kitchens, bathrooms.
- Condensation damage; and failure to follow maintenance and operating instructions.

## **USE, CARE AND MAINTENANCE**

Always raise the blinds if windows and/or doors are open, as a strong breeze could catch and damage the blind.

Avoid exposure to wind or rain, as rain blown onto the blind might stain the fabrics and these spots could be difficult to remove.

### **Operating Roller Blinds**

- To raise the blinds, stand directly in front of the chain, making sure the chain does not rub against the chain wheel mechanism, you will be able to hear and feel the difference.
- If you notice your fabric is tracking or telescoping, please contact CIANI ACT as soon as possible.



## Cleaning Roller Blinds

Choosing the best method of cleaning will depend on the fabric of your blinds.

- Dust with a soft brush or gently sponge clean with warm soapy water, leaving the blinds down to dry.
- Spot clean any marks with a soft damp cloth, make sure the cloth damp not wet to guard against leaving water marks.
- You will also find an art gum eraser will also remove a wide range of service marks.

## Sheer Curtains

Always ensure the curtains are free from obstructions before operating.

Before requesting for service it is necessary to check:

- Any visible damage to the product.
- Check products regularly for signs of wear.

Avoid carrying out any repairs yourself, as warranty will be void in the case of incorrect operation and improper use.

## Care Instructions

Drapery Sheer:

- Do not bleach
- Do not tumble dry
- Drip dry in shade
- Dry-cleaning Gentle cycle
- Low iron max 110c
- Machine wash cool gentle cycle



This Warranty is provided by CIANI ACT Pty Ltd.

Unit 3 / 28 Geelong St Fyshwick ACT 2609

P. 02 6280 7337

M. 0491 610 230

[kay@ciani.com.au](mailto:kay@ciani.com.au)

[sales@ciani.com.au](mailto:sales@ciani.com.au)

[www.ciani.com.au](http://www.ciani.com.au)

## Ways to Group Alpha motors using various remotes.

Grouping can be done in a few ways and it can depend on the particular remote being used. Below I will describe the different ways in different colours.

There is auto grouping on the RE102 or RE302 where if you select the channel that lights up all the LED's, then they are automatically grouped together.

### Multi-Channel control for RE103 and RE303 series remotes

With the models with screens on them, you have the option of using the multi-mode where you can group channels within the remote itself. This works best if you want to group everything together and there is only one multi-mode per remote control. Instructions below:

#### TO SET UP THE GROUP

1. Hold down centre button under the screen until the channel number starts flashing
2. Use the left and right buttons to select the channels you want to group
3. When a number you want to use is flashing, press the centre button and it will box in that number at the bottom of the screen. If you box in the wrong number, press the same button again to un-box it.
4. Repeat step 3 until all the channels you wish to use together are boxed in.
5. When you are finished press the stop button to return to normal use.

#### TO USE MULTI FUNCTION

Press the centre button under the screen and you will see the display toggle between "M" for multi and "S" for single.

If you have "S" displayed then you are only controlling motors assigned to the main channel displayed in the top left of the screen.

If you have "M" displayed then you are controlling all the channels boxed in at the bottom of the screen.

#### Using a spare channel for group operation

If you want to use spare channels on any remote to make a group function, then you simply assign the desired group channel to all the motors you want to include in that group. Each motor will accept up to 15 separate channel assignments.

So if you want to make motors 1,2,3 and 4 a group on channel 10, then simply assign channel 10 to those 4 motors as well as their original channel. The easiest way is as follows:

1. Make sure remote is in single mode if it has a screen
2. Put remote on channel 1
3. Press up/down then stop 8 times and the motor will jiggle (indicating ready to accept another channel)
4. Within 10 seconds, move remote to channel 10, then press up/down followed by stop once
5. If successful, motor will jiggle motor 1 is now also on channel 10
6. Put remote onto channel 2 and repeat steps 3 – 5
7. Put remote onto channel 3 and repeat steps 3 – 5
8. Put remote onto channel 4 and repeat steps 3 – 5
9. During this process some motors may have gone into step by step (incremental) mode
10. Put remote on channel 10 and press up/down followed by stop once, then down (this will exit step by step mode)



Method B. **WARNING:** This will delete ALL remotes assigned to the motor

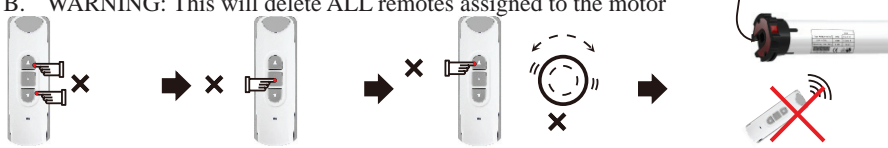

Press the UP and DOWN buttons simultaneously, then release. Press the stop button 6 times. Press the UP button once, the motor will vibrate. All remotes have been deleted from the motor

### ● Changing the motor's direction (You have 10 seconds to complete the task)

Method A



Hold the red button on the motor down for 3 seconds, The motor will vibrate. The UP and Down directions of the motor have been reversed.

Method B



Press the UP and DOWN buttons simultaneously, then release. Press the STOP button 6 times. Press the DOWN button once, the motor will vibrate. The UP and DOWN directions of the motor have been reversed.

### ● Turn on "step by step" mode (motor moves a few milimeters at a time unless button held down for 3 secs)



Press the UP and DOWN buttons simultaneously, then release. Press the STOP button once. Press the UP button once, the motor will vibrate. The motor is now in "step by step" mode.

### ● Turn off "step by step" mode (motor will run up and down as normal)



Press the UP and DOWN buttons simultaneously, then release. Press the STOP button once. Press the DOWN button once, the motor will vibrate. The motor will now run normally

### ● Setting the TOP limit (You have 10 seconds to complete the task)



Press the UP and DOWN buttons simultaneously, then release. Press the STOP button twice. Press the UP button once, the motor will vibrate. Top limit is now set.

### ● Setting the BOTTOM limit (You have 10 seconds to complete the task)



Press the UP and DOWN buttons simultaneously, then release. Press the STOP button twice. Press the DOWN button once, the motor will vibrate. Bottom limit is now set.

### ● Deleting the Top limit (You have 10 seconds to complete the task)



Press the UP and DOWN buttons simultaneously, then release. Press the STOP button 4 times. Press the UP button once, the motor will vibrate. Top limit is deleted

### ● Deleting the Bottom limit (You have 10 seconds to complete the task)



Press the UP and DOWN buttons simultaneously, then release. Press the STOP button 4 times. Press the Down button once, the motor will vibrate. Bottom limit is deleted

### ● Setting the third limit (Mid way position, somewhere between top and bottom limits)



Press the STOP button 4 times. The motor will vibrate. Holding down the stop button for 2 seconds will send the motor to the third limit position.

### Changing the third limit



Press the STOP button 4 times. The motor will vibrate. Holding down the stop button for 2 seconds will send the motor to the third limit position.

NOTE: The third limit will be deleted automatically if either the top or bottom limits are deleted.

